

TYPICAL DETAILS OF FORM FINISHED EXPOSED RCC SHUTTERING PATTERNS

01. FORM FINISHED EXPOSED RCC WALLS

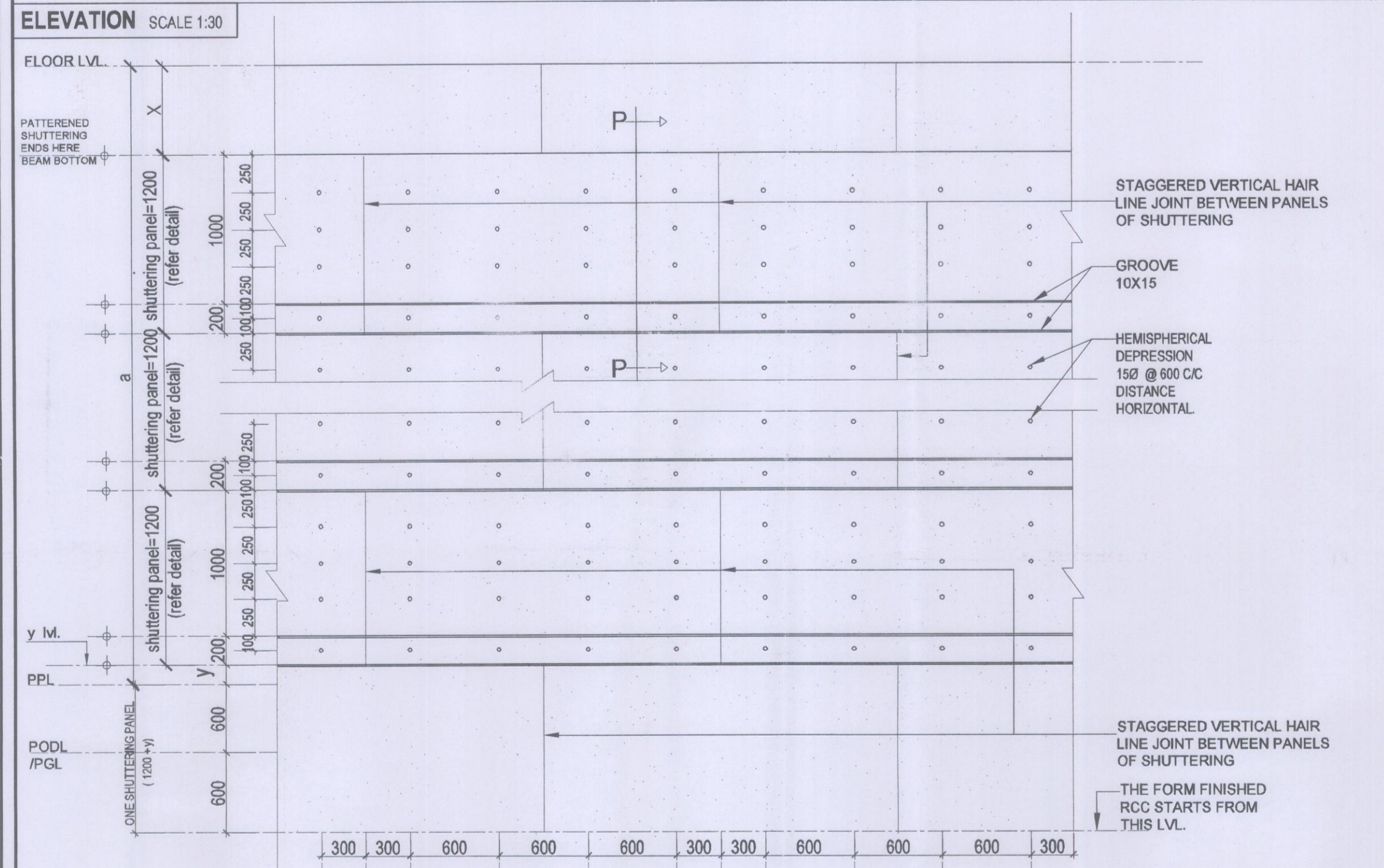

DETAIL AT P-P WITH DETAIL OF ONE SHUTTERING PANEL

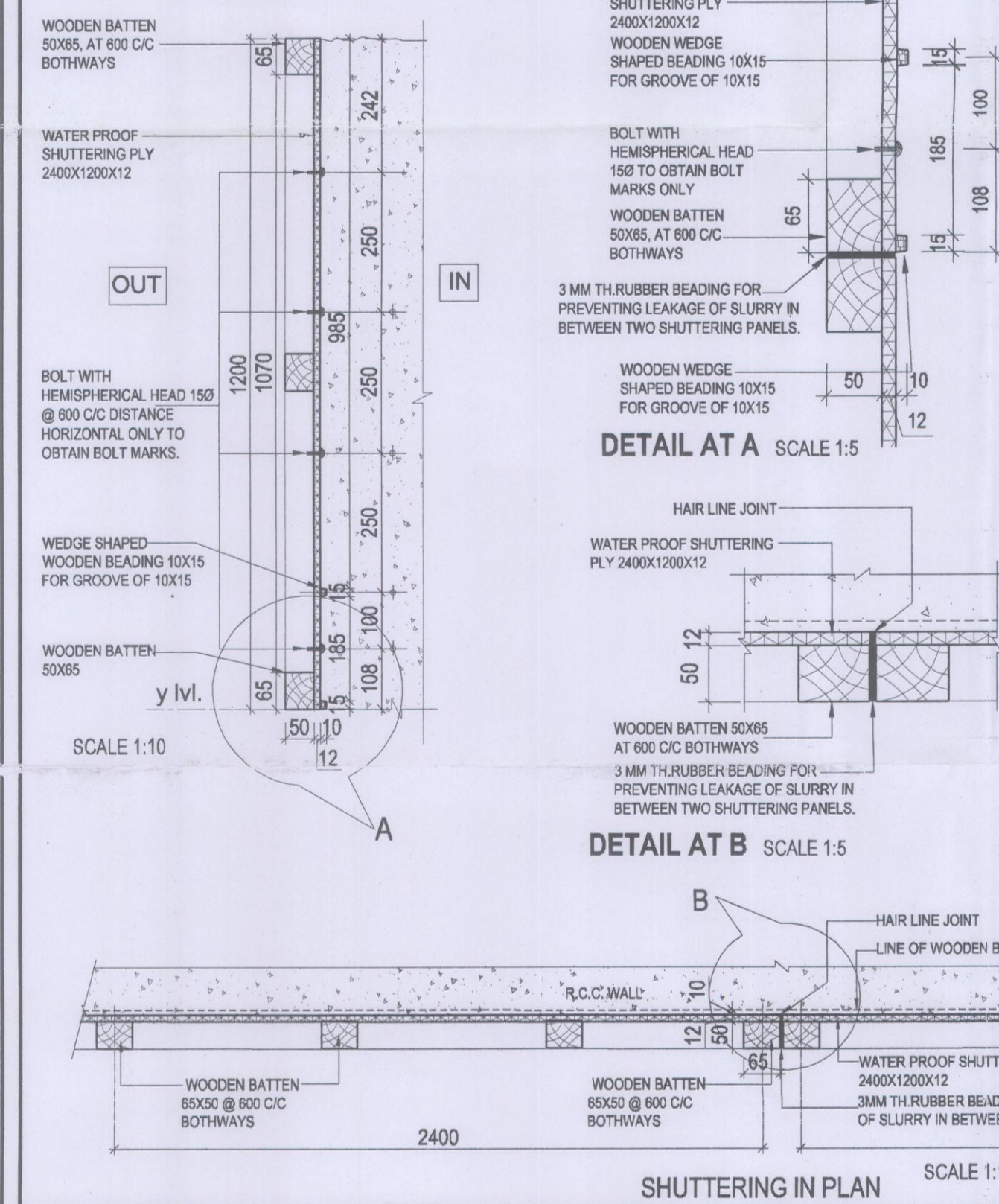

FORMULA TO OBTAIN 'y'

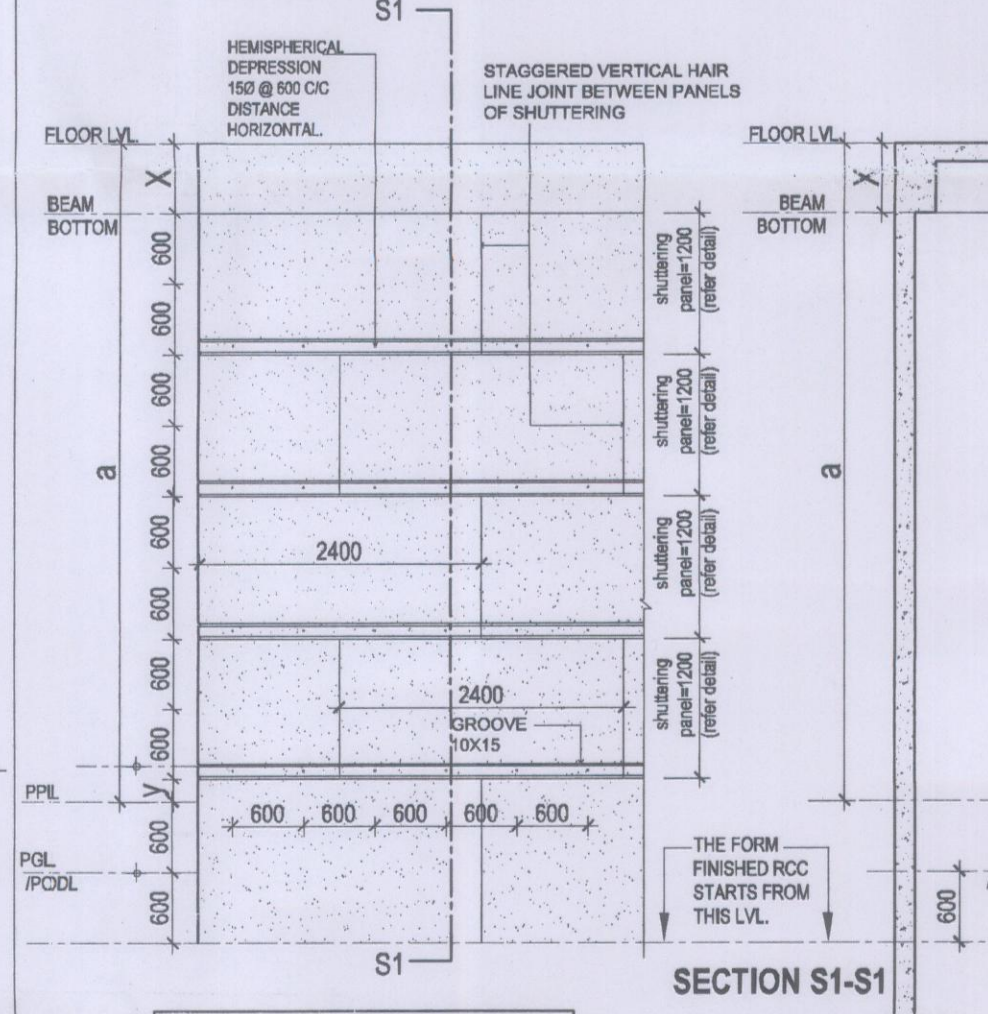

$y = a - x - [n(1200)]$

where,
 $y =$ ht. of first groove from PPL
 $a =$ total ht. of the R.C.C. wall as shown.
 $x =$ beam depth from slab top to beam bottom
 $n =$ nos. of complete shuttering panels (1200 high) in 'a'.

02. FORM FINISHED EXPOSED RCC PARAPETS

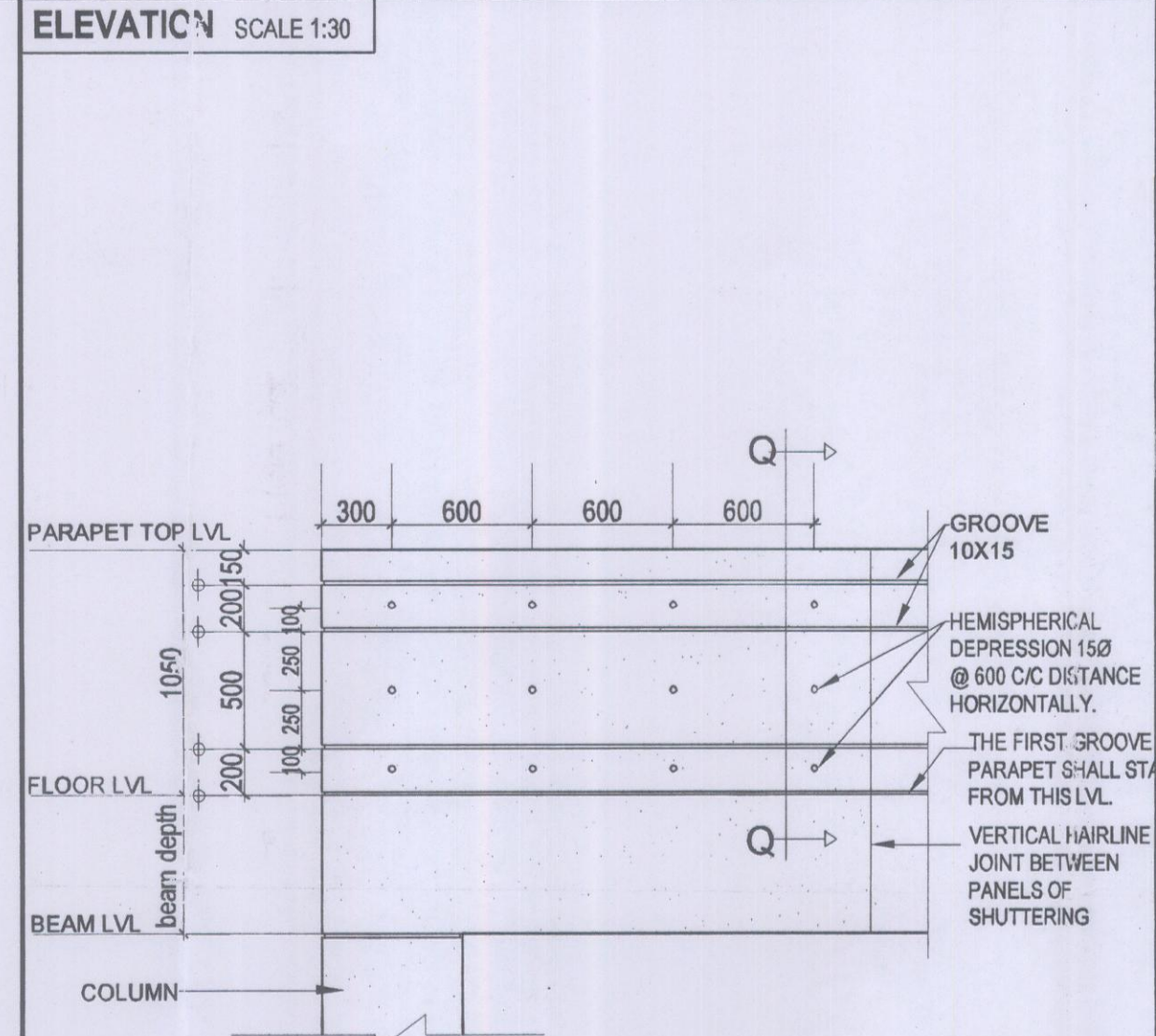

DETAIL AT Q-Q WITH DETAIL OF ONE SHUTTERING PANEL SCALE 1:10

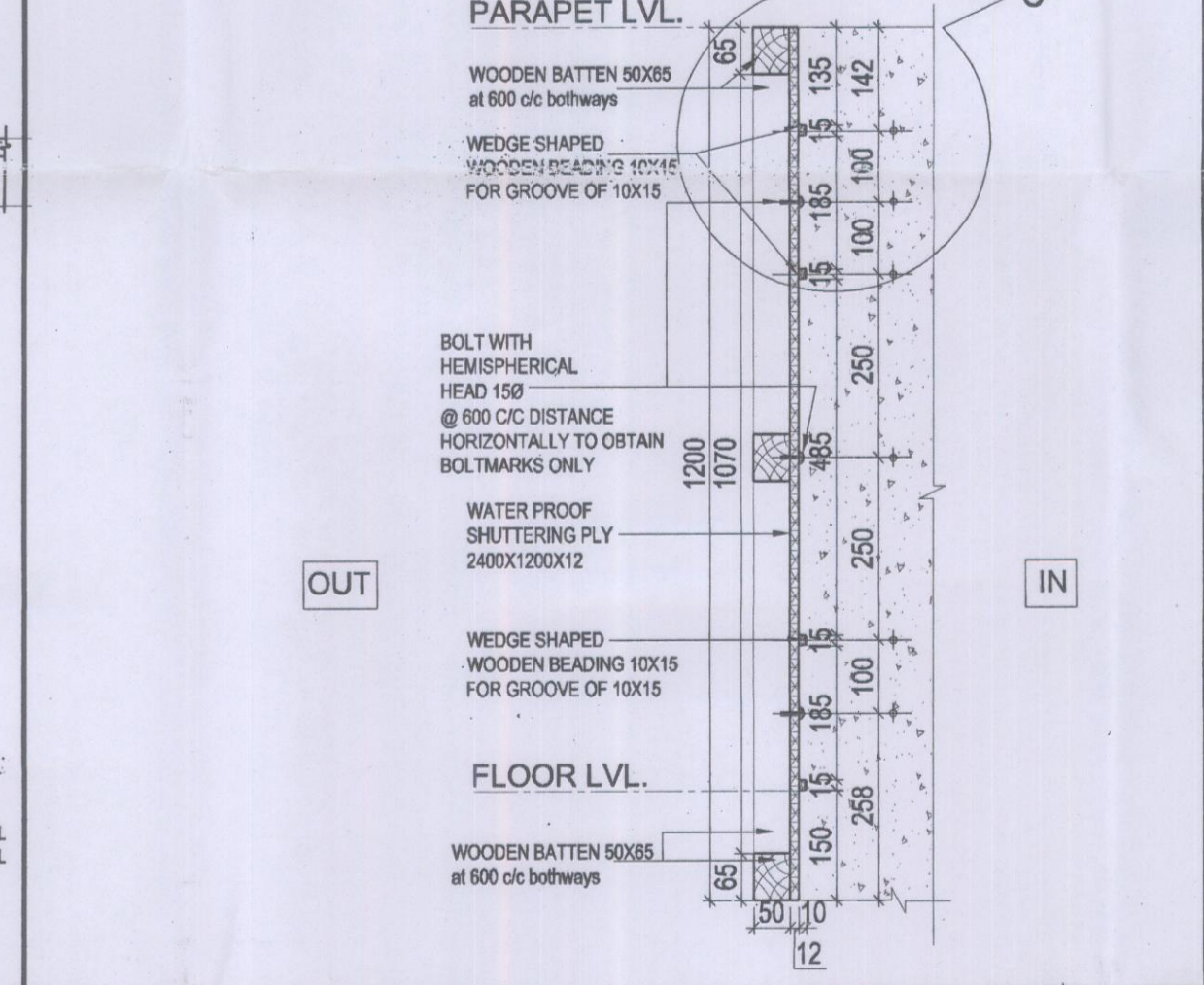

DETAIL AT D SCALE 1:5

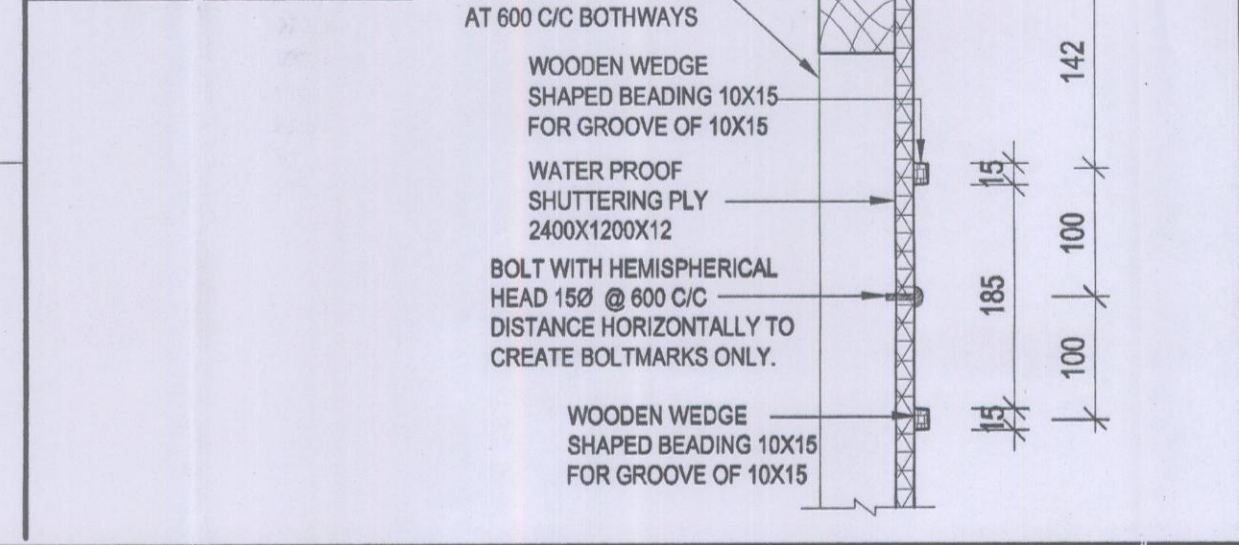

03. FORM FINISHED EXPOSED RCC COLUMNS

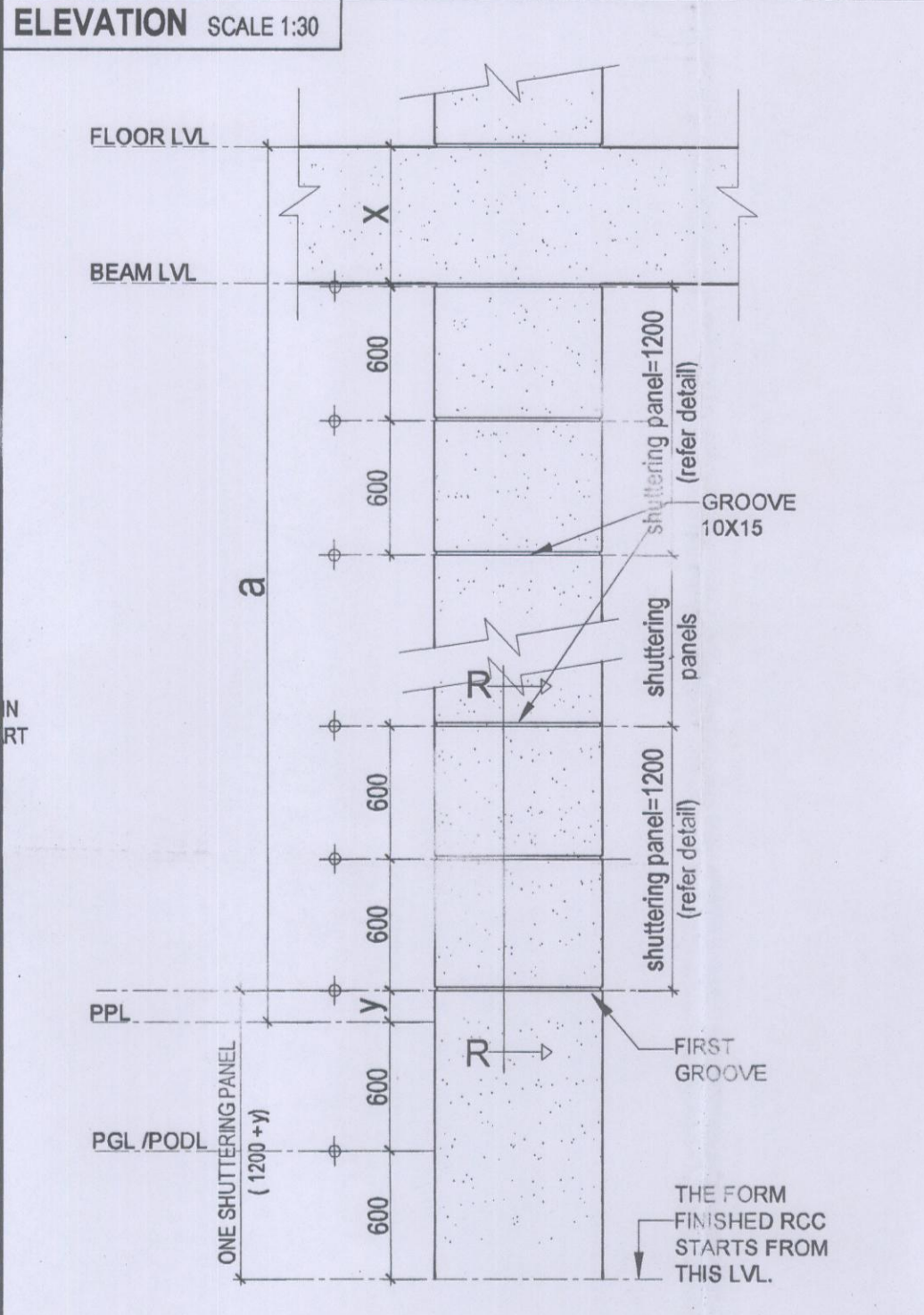

DETAIL AT R-R WITH SHUTTERING (1:10) FORMULA TO OBTAIN 'y'

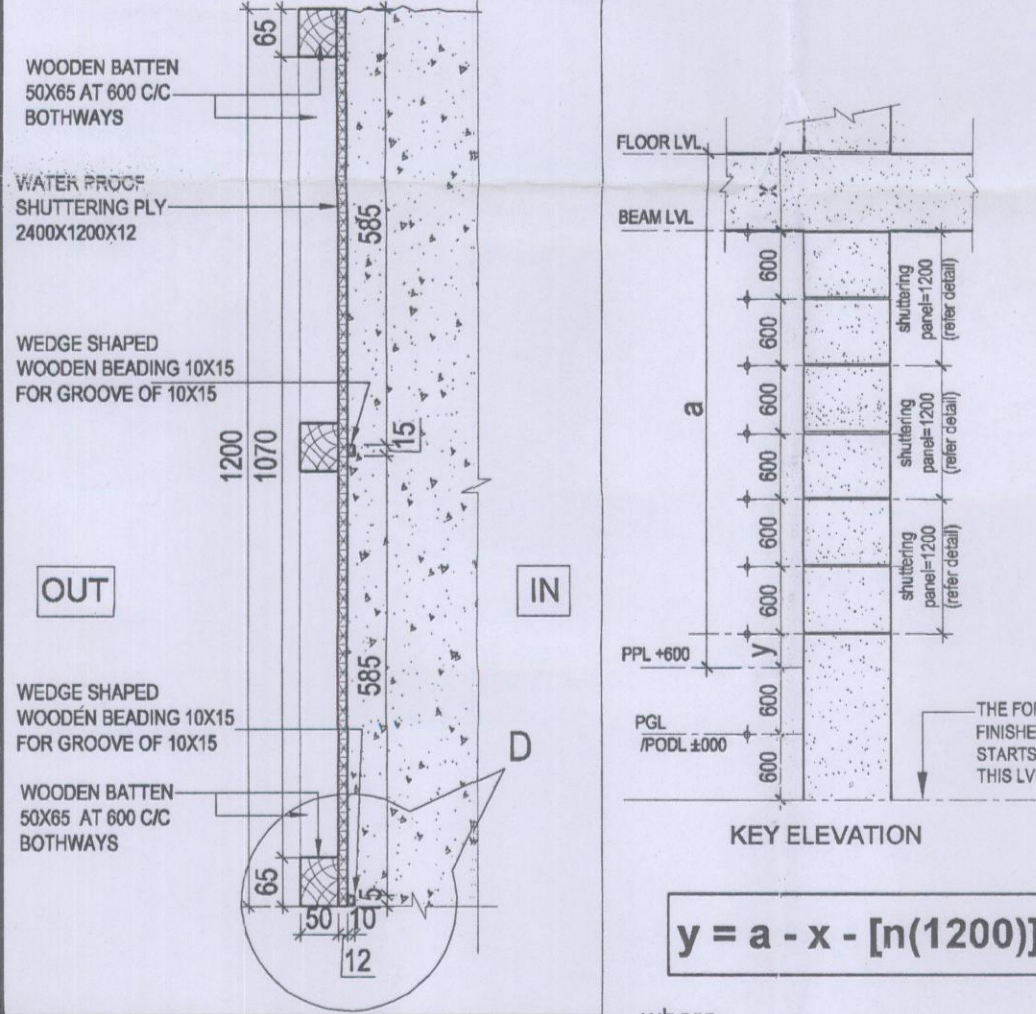

DETAIL AT D SCALE 1:5

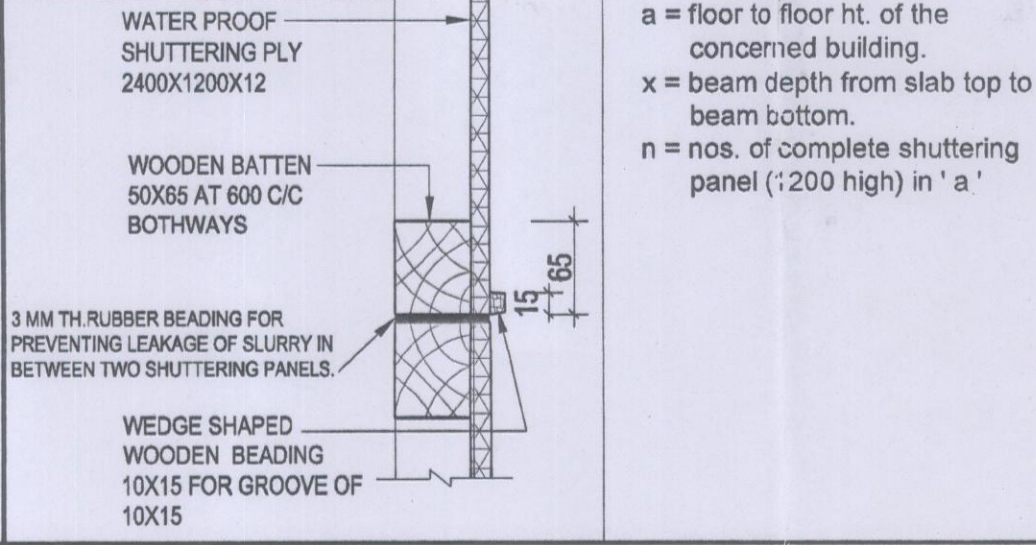

$y = a - x - [n(1200)]$

where,
 $y =$ ht. of first groove above PPL
 $a =$ floor to floor ht. of the concerned building.
 $x =$ beam depth from slab top to beam bottom.
 $n =$ nos. of complete shuttering panel (1200 high) in 'a'

- NOTES
1. ALL DIMENSIONS ARE IN MM.
 2. WRITTEN DIMENSIONS SHALL BE FOLLOWED.
 3. ANY DISCREPANCY IN THIS DRAWING SHALL BE BROUGHT TO THE NOTICE OF THE ARCHITECT BEFORE EXECUTION.
 4. THIS DRAWING IS THE PROPERTY OF THE ARCHITECT AND SHALL NOT BE USED OR REPRODUCED WITHOUT PERMISSION.
 5. 12 MM THICK SHUTTERING PLY SHALL BE USED TO OBTAIN FORM FINISH. THIS PLY SHALL NOT BE USED FOR MORE THAN FOUR TIMES ON ONE SIDE. THAT IS TOTAL NUMBER OF USES SHALL BE RESTRICTED TO EIGHT, CONSIDERING BOTH SIDES OF THE WATERPROOF SHUTTERING PLY.
 6. THE SHUTTERING PATTERN IN ALL BUILDINGS WHERE EXPOSED FORM FINISHED R.C.C. HAS BEEN SPECIFIED BY THE INSTITUTE SHALL CONSIST OF GROOVES OR BOLT MARKS OR BOTH.
 7. IN CASE OF COMPOSITE R.C.C. WALL AND COLUMN CONFIGURATION, THE PATTERN SHALL FOLLOW AS GIVEN IN R.C.C. WALL. THIS PATTERN WILL BE DEVELOPED ONLY ON EXPOSED SURFACES.
 8. THE FRAME OF THE SHUTTERING PANEL CAN BE MODIFIED AS PER SITE CONDITIONS WITHOUT DISTURBING THE FORM FINISHED EXPOSED R.C.C. PATTERN.

GOOD FOR CONSTRUCTION
 For 19/01/16
 ARCHITECTS
 COSMIC DESIGNS (P) LTD.
 17-A, FIRST FLOOR
 JOPLING ROAD, LUCKNOW

- LEVELS
1. AEGL = AVERAGE EXISTING GROUND LEVEL
 2. PGL = PROPOSED GROUND LEVEL =
 3. PODL = PODIUM LEVEL
 4. PPL = PROPOSED PLINTH LEVEL

REV. NO.	DATE	REMARK

PROJECT:
 INDIAN INSTITUTE OF SCIENCE
 EDUCATION & RESEARCH
 AT MOHALI, PUNJAB

BUILDING:
 ALL BUILDINGS WITH FORM FINISHED
 EXPOSED R.C.C..

DRG. TITLE:
 TYPICAL DETAILS OF FORM FINISHED EXPOSED
 R.C.C. PATTERNS.

NORTH	DATE	DRAWING NO.
	15/01/10	1000/AL/1032/R0

SCALE
 1:30

ARCHITECT- D.S.BHUI

COSMIC DESIGNS PVT. LTD.
 17-A, JOPLING ROAD, LUCKNOW
 PH: 9522-2297/952