

PROJECT:
WALKWAY
 IISER MOHALI

LEGEND

SCHEDULE
 ALUMINIUM AND GLASS

DRAWING NO.:
01

DRAWING TYPE:
MASTERPLAN
WALKWAY+TRELLIS

DESIGNED BY:
JAIN AND PARTNERS
 COVER BY:
JASBINE GADGI
 DATE:
18.11.2024
 MR. JASBINE GADGI
 MOBILE: 911024110241
 EMAIL: jasbinesg@jainandpartners.com

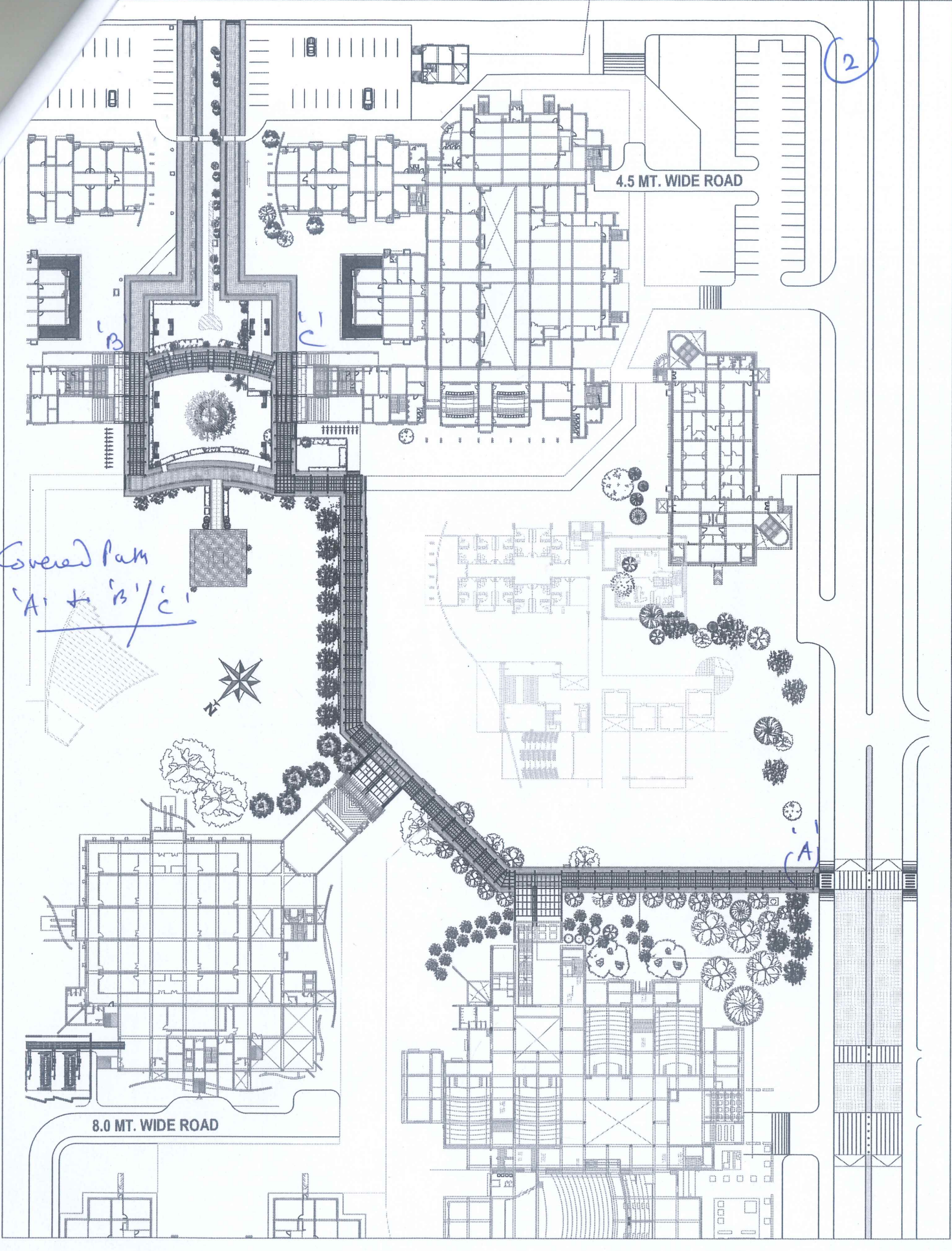

2

4.5 MT. WIDE ROAD

8.0 MT. WIDE ROAD

Covered Path
 A + B + C

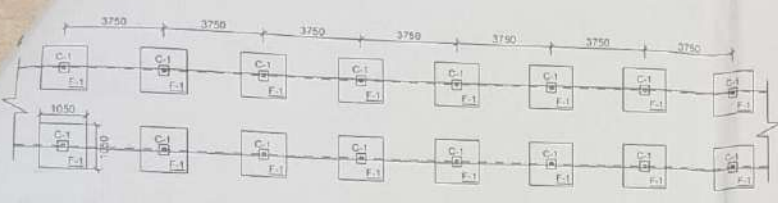

| Sr No | MEMBER DESIGNATION | SIZE |
|-------|--------------------|----------------------------|
| 1 | COL. C-1 | SHS 113.5 x 113.5 x 4.8 MM |
| 2 | BASE PLATE | 300 x 300 x 12 MM THK. |
| 3 | PURLIN P-1 | RHS 50 x 40 x 4 MM |
| 4 | RAFTER R-1 | RHS 145 x 82 x 5.4 MM |

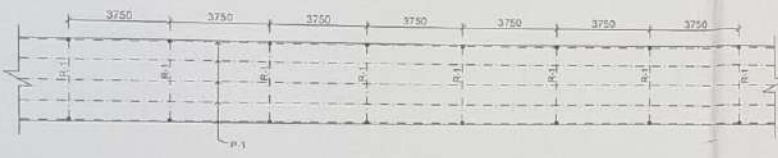

- NOTES:
1. THIS DRAWING SHALL BE READ IN CONJUNCTION WITH THE RELEVANT ARCHITECTURAL DRG.
 2. STRUCTURAL STEEL SHALL CONFORM TO IS: 2002.
 3. WELD THICKNESS = 5MM THICK.
 4. ANY DISCREPANCY BETWEEN THE VARIOUS DRAWINGS SHALL BE BROUGHT TO THE NOTICE OF THE CONCERNED CONSULTANT.
 5. THE DRAWING SHALL NOT BE SCALED, ONLY WRITTEN DIMENSIONS TO BE FOLLOWED.
 6. PER-316 BRASS STRUCTURAL TUBE SECTION FOR ALL STEEL WORK.
 7. ALL WELDS SHALL CONFORM TO IS: 81 1984 / IS 9555 1999 AND SHALL BE A FILTER WELD PATTERN (UNLESS OTHERWISE SPECIFIED).
 8. ALL BELOW SECTION SHOULD BE WELDED THROUGHOUT THE PERIMETER OF CONNECTED AREA 5MM WELD TO BE USED FOR ALL CONNECTIONS.
 9. THERE SHOULD NOT BE MORE THAN TWO JOINTS IN ANY MEMBER.
 10. BOLT USED SHALL CONFORM TO IS 3757.
 11. CONCRETE GRADE OF M 25 SHOULD BE USED.
 12. FE 500 GRADE STEEL TO BE USED AS PER IS 1786: 2008.
 13. ϕ - INDICATES THE DIAMETER OF HYSD BARS.

SUSHIL DOGRA
B.E. (Civil), M.E. (Structures)

STRUCTURAL CONSULTANT
CREATIVE CONSULTANTS
 SRI GURU HAR RAI SAHIB COMPLEX
 2402, TOP FLOOR, SECTOR - 57,
 MOHALI (Near Chandigarh)
 Ph. No. 9875674540, 9316105088 (M)

PROJECT
 PATHWAYS IISER MOHALI

TITLE OF DRG
 PATHWAYS SHED FOUNDATION PLAN & DETAILS

| SCALE | DATE | DEALT | DSND/CHKD | APP BY | JOB. NO. | DRG. NO. | S : 001 | REVI NO. |
|-------|-----------|----------|------------|--------|----------|----------|---------|----------|
| | DEC. 2024 | VAISHALI | S.K. DOGRA | | | | | |

