

**lwb1**; island work bench. 2440\*1500\*900high

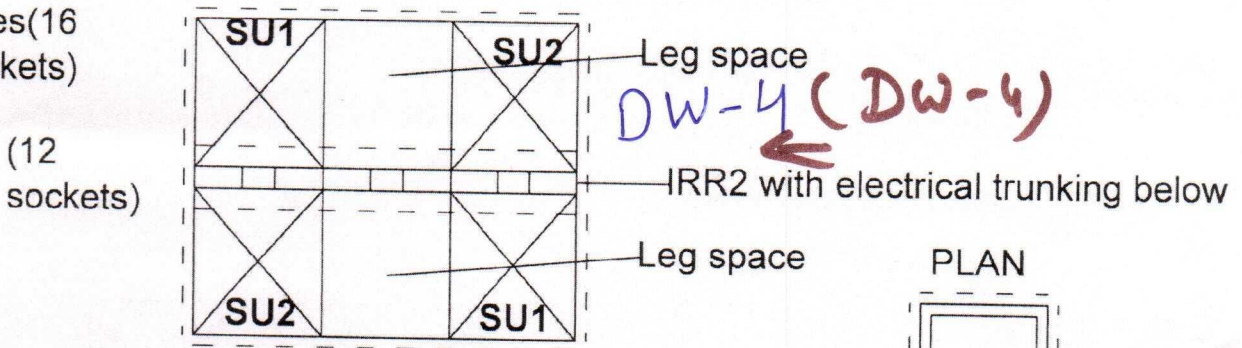

**lwb2**; island work bench. 1800\*1500\*900high

PLAN

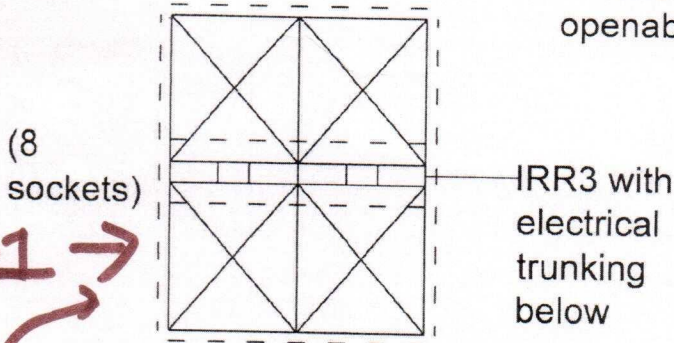
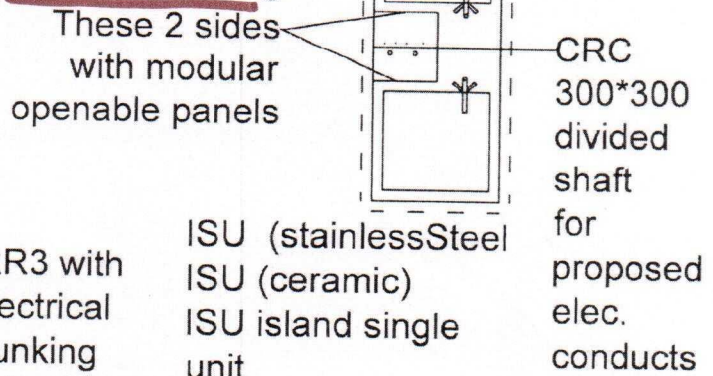

**lwb3**; island work bench. 1220\*1500\*900high

PLAN

**lwb4**; island work bench. 915\*1500\*900high

**DW-1**

(DW 3 & 2) Dimensions as per the indent.

- DW-3+2

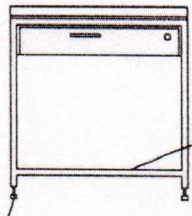

Footrest 200 inside from front

leveling screw

STT1 ; student writing table 750,600,750high (including leveling screw)

STT2 ; " " 1500,600,750high

Bearer for slider's

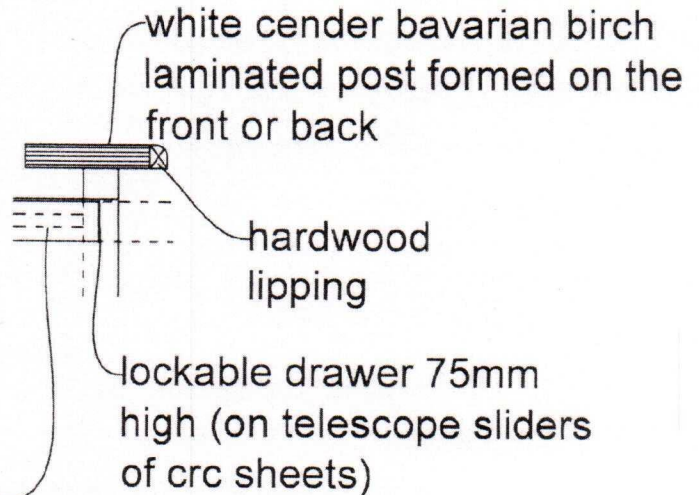

List of additional types tables with some changes based on ww (wall work beanch) on sheats 1 and 2;

WWB1W; wall work beanch 8',2'wide,3'high with

WWB2W; " " 6',2'wide,3'high

WWB3W; " " 4',2'wide,3'high

SSP2 ; special table 6' ,4'wide,2'6"high with white top

SPT3 ; " " 4',4'wide 2'6" high. SPT3

STT1 ; students'writing table 2'6"long, 2'6"wide and 2'6"high with laminate top (see detail SST1alone) and 1drawer 3" high 2'6"(n)

SST2 ; " " 5'long,2'wide,2'6"high with 2 drawers 2'6" wide(n)3" high STT2

BSU ;big sink unit

ISU ;islant utility shaft



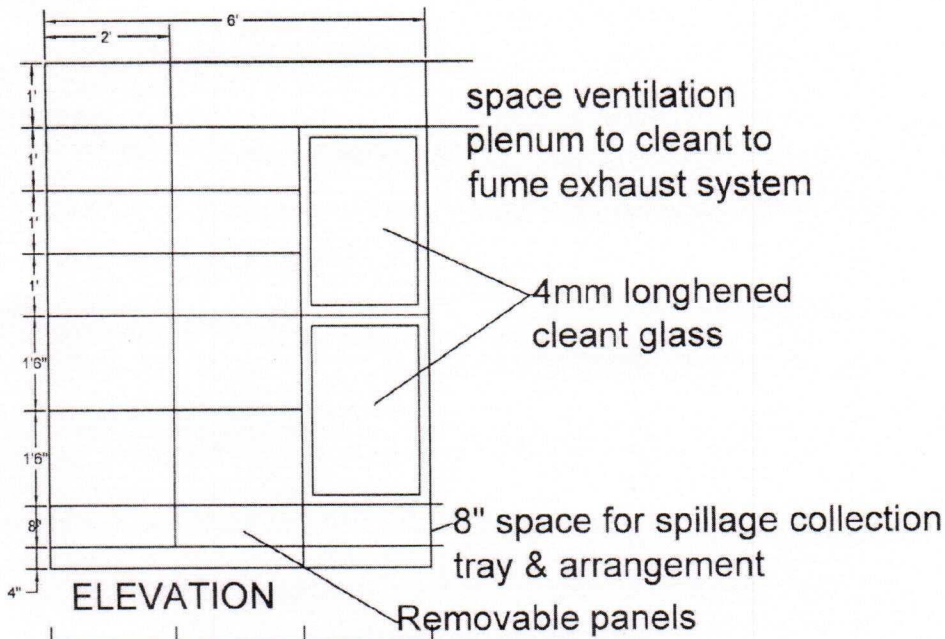

shelves shown without shutter  
 shutter for clarity shown without shelves

- All the 3 shutter and 3 bottom shutter shaft the individually lockable brushed stainless pull handles to be provided
- leveling bolts/brushes to provided at the bottom

**VCC:** Ventilation chemical copboard (vcc) 2'6" deep  
 (To be constructed out of crc sheets with each shelf beaing with adequate stiffenets to take the loading (1 shelves 10 kgs; 1'6"shelves; 20kgs each)

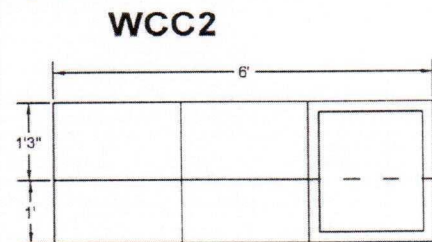
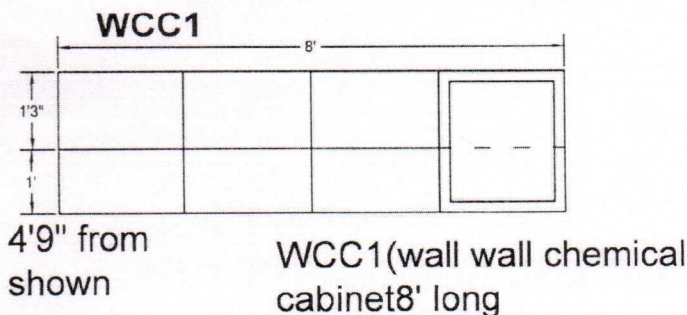

2ms 15/5 amp out lets every 2'

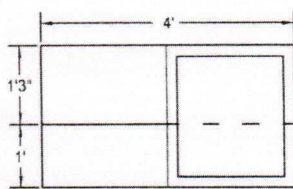

- Only one shutter shown for clerity in each cabinet
- All cabinets 1'3" deep
- Electrical trunking tube provided below all cabinets

DW-5

DW-5



**WWB1**

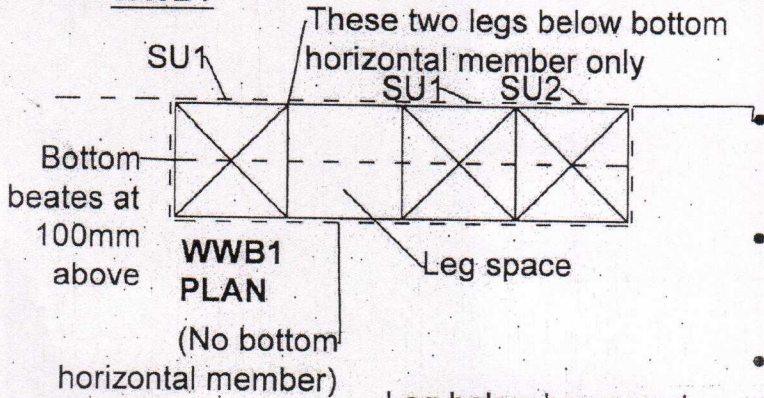

- Granite top projection 75mm at the back (No rounding) with 100 high splashrack of same material
- Other 3 sides projected to be 50mm top edge 1/4 rounded and polished
- Note; where 2 unit are fomed that side not to be rounded but straight cut and polished

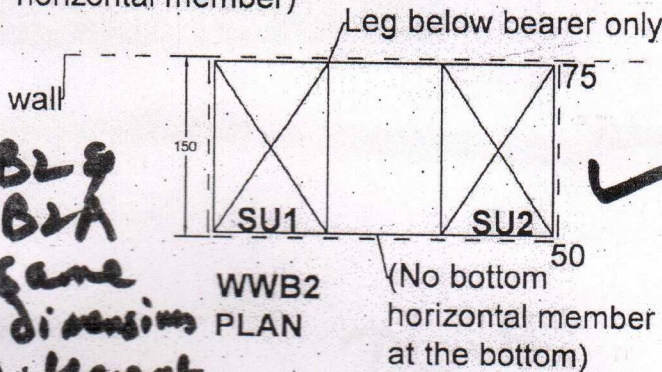

*WWB2 & WWB2A are same but dimensions are different*

- All storage units should name group rocking system (or all drawers in one vertical now should have one key)

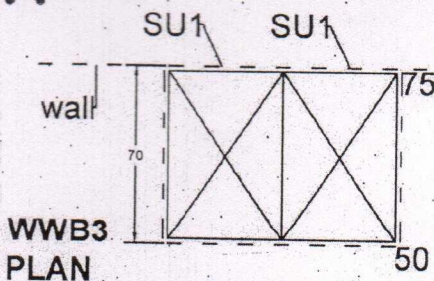

*DW-6  
9  
DW-7*

**WALL SINK UNIT**

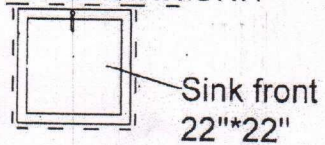

WSU(ss); Stainless Steel Sink  
WSU(c); Ceramic Sink  
(600 wide, 900 deep, 900 high)

- All work benches 900 and 750mm deep (all work top sides)
- WWB1; wall work bench 2440 (8') long.
- WWB2; wall work bench 1830 (6') long.
- WWB2 1500 long. *(WWB2 A)*
- WWB3; wall work bench 1220 long.
- WSU; sink unit against wall 610 long.

WWB2N; wall work bench  
6'3" high \* 2' wide  
• WWB2WD; " " "  
6'3" high \* 3' wide  
• WWB3WD; " " "  
4'3" high \* 3' wide

- Expect where mentionel otherwise all tops will be 1st quality plain jet black ceramic polished and rounded/straight cut as below
- see sheet 3 below

*Dimension*



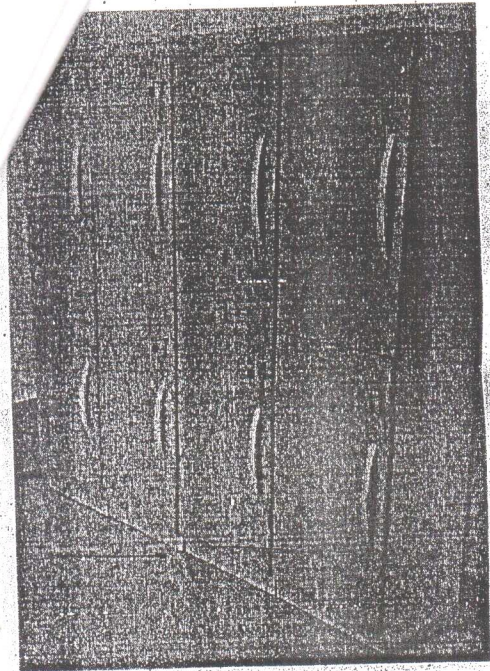

DW-8